

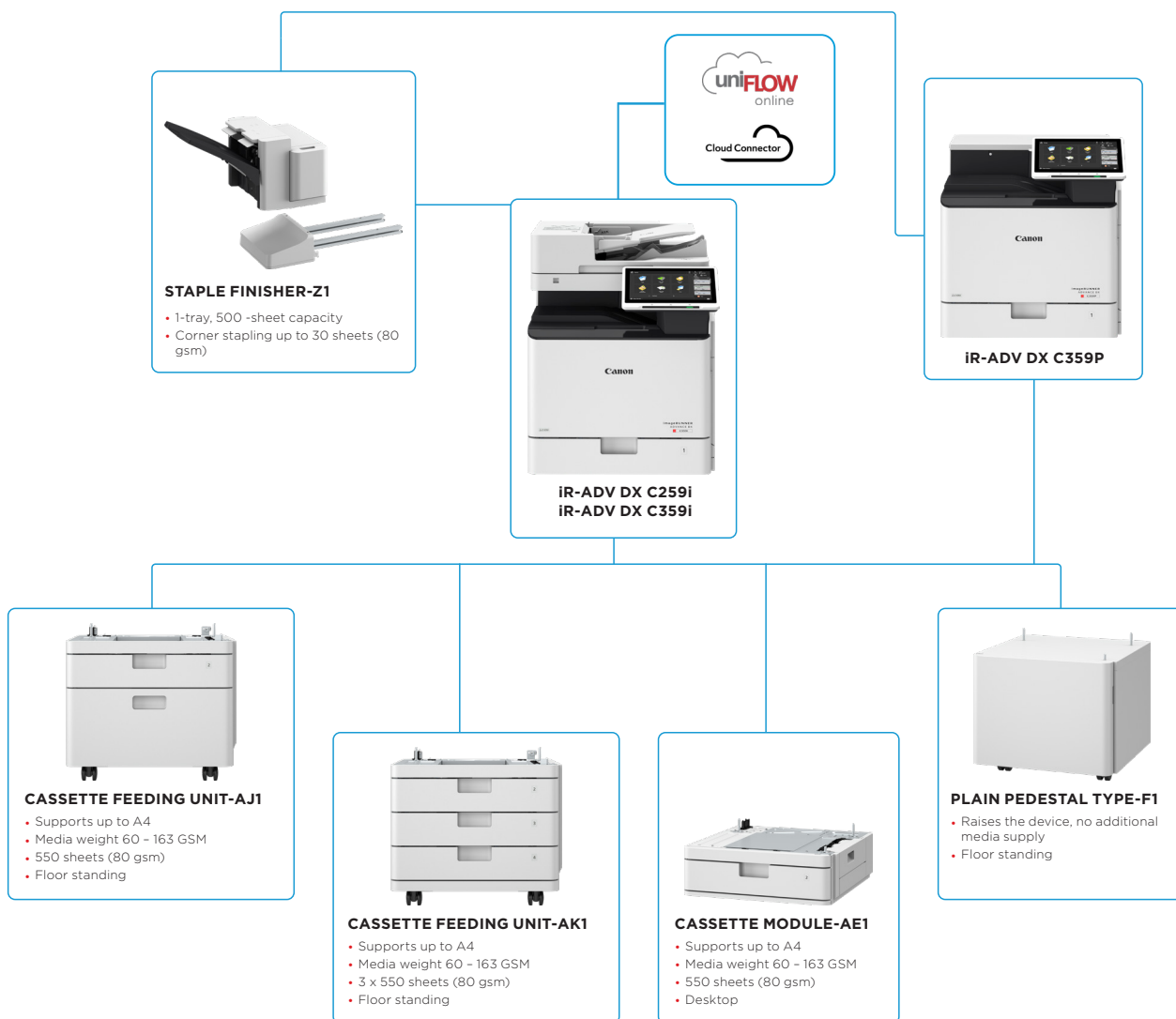

Canon Europe Ltd.
B112020204 How: 044 899 43 Brand

COMPACT COLOUR A4 DEVICES WITH STREAMLINED WORKFLOWS FOR FAST, HIGH-QUALITY PRINTING AND SCANNING.

MAIN CONFIGURATION OPTIONS



This flat configuration is for illustration purpose only. For a complete list of options and the exact compatibility relationships, please refer to the [online product configurator](#).

The Unified Firmware Platform (UFP) ensures that the latest feature upgrades and protection are available, for an enhanced user experience across the entire iR ADVANCE DX portfolio.

TECHNICAL SPECIFICATIONS

imageRUNNER ADVANCE DX C259/C359 Series

MAIN UNIT		Operating System	UFR II: Windows® 8.1/10/11/Server2012/Server2012 R2/Server2016/Server2019/Server2022, Mac OS X (10.11 or later)
Machine type	A4 Colour Laser Multifunctional		
Core functions	Print, Copy*, Scan*, Send*, Store and Optional Fax* * Not applicable to iR-ADV DX C359P (Printer model)		
Processor	1.8GHz Dual Core Processor		
Control Panel	10.1" TFT LCD WSVGA Color Touch panel		
Memory	Standard: 4GB RAM		
Hard Disk drive	Standard: (SSD) 256 GB		
Interface Connection	NETWORK Standard: 1000Base-T/100Base-TX/10Base-T Optional: Wireless LAN (IEEE 802.11 b/g/n) OTHERS Standard: USB 2.0 (Host) x1, USB 3.0 (Host) x1, USB 2.0 (Device) x1; Optional: Serial Interface, Copy Control Interface	COPY SPECIFICATIONS	
		Copy Speed* (BW/CL)	iR-ADV DX C359i 35 ppm (A4), 26 ppm (A5R), 61 ppm (A5), 23 ppm (A6) iR-ADV DX C259i 25 ppm (A4), 26 ppm (A5R), 46 ppm (A5), 23 ppm (A6) * Single-sided
Paper Supply Capacity (A4, 80gsm)	Standard: 650 Sheets 100-sheets Multi-purpose tray 550-sheets Paper cassette x1 Maximum: 2,300 Sheets (with Cassette Feeding Unit-AK1)	First-Copy-Out Time (A4; BW/ CL)	iR-ADV DX C359i: Approx. 5.1/6.9 seconds or less iR-ADV DX C259i: Approx. 6.9/9.4 seconds or less
Paper output capacity (A4, 80gsm)	Standard: 250 Sheets Maximum: 500 Sheets (with Staple Finisher-Z1)	Copy resolution (dpi)	600 x 600, 300 x 600
Finishing capabilities	Standard: Collate, Group With Finisher : Collate, Group, Offset, Staple	Multiple Copies	Up to 999 copies
Supported media types	Multi-purpose tray: Thin, Plain, Heavy, Recycled, Color, Transparency, Pre-punched, Bond, Label, Envelope Paper Cassette: Thin, Plain, Heavy, Recycled, Color, Pre-punched, Bond, Envelope*	Copy Density	Automatic or Manual (9 Levels)
Supported media sizes	Multi-purpose tray: Standard size: A4, A5, A5R, A6, B5, Custom Size: 98.0 x 148.0 mm to 216.0 x 355.6 mm Envelopes: COM10 No.10, Monarch, DL, ISO-C5 Envelope custom size: 98.0 x 148.0 mm to 216.0 x 355.6 mm Paper Cassette: Standard size: A4, A5, A5R, A6, B5, Custom size: 98.0 x 190.5 mm to 216.0 x 355.6 mm Envelopes: COM10 No.10, Monarch, DL, ISO-C5	Magnification	Variable zoom: 25% to 400% (1% Increments) Preset reduction/enlargement: 25%, 50%, 70%, 100%(1:1), 141%, 200%, 400%
Supported media weights	Multi-purpose tray: 60 to 220 gsm Cassette: 60 to 163 gsm Duplex: 60 to 163 gsm	Copy Features	Preset R/E Ratios by Area, Two-Sided, Density Adjustment, Original Type Selection, Interrupt Mode, Two-sided Original, Job Build, N on 1, Page Numbering, Copy Set Numbering, Sharpness, Erase Frame, Secure Watermark, Print Date, Copy ID Card, Skip Blank Pages, Color Mode, Reserved copy, Copy Sample
Warm-up Time	Quick Startup Mode: 4 seconds or less* (applicable to C359i/C259i) * Time from device power-on to when the copy icon appears and is enabled to operate on the touch panel display. From Sleep Mode: 10 seconds or Less From Power On: 10 seconds or Less* * iR-ADV DX C359i/C259i: Time from device power-on, until copy ready (not print reservation) * iR-ADV DX C359P: Time from device power-on, until print ready (not print reservation)	SCAN SPECIFICATIONS	
Dimensions (W x D x H)	iR-ADV DX C359i/C259i: 519 x 658 x 638 mm iR-ADV DX C359P: 519 x 658 x 525 mm	Standard type	Single-pass Duplexing Automatic Document Feeder* [2-sided to 2-sided (Automatic)] * Detect Feeder Multi Sheet Feed is supported.
Installation Space(W x D)	Basic: 852 x 908 mm (with Multi-purpose tray extended + paper cassette open) Fully Configured: 1,407 x 908 mm (with Staple Finisher-Z1 + Multi-purpose tray extended + paper cassette open)	Document Feeder Paper Capacity (80 gsm)	100 Sheets
Weight	iR-ADV DX C359i/C259i: Approx. 48 kg (including toner) iR-ADV DX C359P: Approx. 41 kg (including toner)	Acceptable originals and weights	Platen: Sheet, Book, and 3-Dimensional Objects Document Feeder media weight : 1-sided scanning: 42 to 128 gsm (BW), 64 to 128 gsm (CL) 2-sided scanning: 50 to 128 gsm (BW), 64 to 128 gsm (CL) Note: Business card: 80 to 220 gsm Original width narrower than A6 except business card: 50 to 128 gsm
PRINT SPECIFICATIONS		Supported media sizes	Platen scanning size: up to 216.0 x 355.6 mm Document Feeder media size: A4, A5R, A6, B5, Custom size: 48.0 x 128.0 mm to 216.0 x 355.6 mm Business card: 48.0 x 85.0 mm to 55.0 x 91.0 mm
Print Speed*	iR-ADV DX C359i/C359P 35 ppm (A4), 26 ppm (A5R), 61 ppm (A5), 23 ppm (A6) iR-ADV DX C259i 25 ppm (A4), 26 ppm (A5R), 46 ppm (A5), 23 ppm (A6) *1-sided	Scan Speed (ipm: BW/CL, A4)	Send (300 x 300 dpi): up to 95/190 when Automatic Colour Select "OFF" 1-sided Scanning: 95 2-sided Scanning: 190 Automatic Color Select "ON": 1-sided Scanning: 50 2-sided Scanning: 100 Copy: Scan Speed priority (300 x 600 dpi): 1-sided Scanning: 50 2-sided Scanning: 100 Image Quality priority (600 x 600 dpi): 1-sided Scanning: 30 2-sided Scanning: 50
Duplex Print Speed (A4/LTR)	iR-ADV DX C359i/C359P: BW 35ipm/36ipm, CL 35ipm/36ipm C259i: BW 25ipm/26ipm, CL 25ipm/26ipm	Scan Resolution (dpi)	Scan for Copy: up to 600 x 600 Scan for Send: (Push) up to 600 x 600 (SMB/FTP/WebDAV/IFAX), (Pull) up to 600 x 600 Scan for Fax: up to 600 x 600
Print Resolution (dpi)	600 x 600 to 1,200 x 1,200 (equivalent)	Pull Scan Specifications	Colour Network ScanGear2. For both TWAIN and WIA Supported OS: Windows®7/ 8.1/ 10/ Server2008/ Server2008 R2/ Server2012/ Server2012 R2/ Server 2016 As of Feb. 2020
Page description languages	Standard: UFR II, PCL6, Adobe® PostScript® 3™	Scan Method	Push Scan, Pull Scan, Scan to Box, Scan to Advanced Space, Scan to Network, Scan to USB Memory Key, Scan to Mobile devices, Scan to cloud (uniFLOW Online, Cloud Connector - Optional)
Direct Print	Supported file types: TIFF, JPEG, PDF, EPS, and XPS	SEND SPECIFICATIONS	
Printing from mobile and cloud	AirPrint, Mopria, Universal Print by Microsoft, Canon PRINT and uniFLOW Online A range of software and MEAP-based solutions are available to provide printing from mobile devices or internet-connected devices and cloud-based services depending on your requirements. Please contact your sales representative for further information	Destination	Standard: E-mail/Internet FAX (SMTP*), SMB 3.1.1, FTP, WebDAV, Mail Box Optional: Super G3 FAX, IP Fax (for iR-ADV DX C359i/C259i) * OAuth 2.0 authentication method available for Microsoft 365 and Google Workspace.
Fonts	PS fonts: 136 Roman PCL fonts: 93 Roman, 10 Bitmap fonts, 2 OCR fonts, Andalé Mono WT J/K/S/T [†] (Japanese, Korean, Simplified and Traditional Chinese), Barcode fonts [†] [†] Optional PCL International Font Set-A1 is required. ^{††} Optional Barcode Printing Kit-D1 is required.	Address Book	LDAP (2,000)/Local (1,600)/Speed dial (200)
Print Features	Secured Print, Secure Watermark, Header/Footer, Page Layout, Two-sided Printing, Toner Reduction, Poster Printing, Forced Hold printing, Print Date, Scheduled Printing, Printing Using a Virtual Printer	Send resolution (dpi)	Push: up to 600 x 600 Pull: up to 600 x 600
		Communication protocol	File: FTP(TCP/IP), SMB 3.1.1 (TCP/IP), WebDAV E-mail/I-Fax: SMTP, POP3
		File Format	Standard: TIFF, JPEG, PDF (Compact, Searchable, Apply policy, Optimize for Web, PDF A/1-b, Trace & Smooth, Encrypted, Device Signature, User Signature), XPS (Compact, Searchable, Device Signature, User Signature), Office Open XML (PowerPoint, Word)

TECHNICAL SPECIFICATIONS

imageRUNNER ADVANCE DX C259/C359 Series

Universal Send Features	Original Type Selection, Two-sided Original, Density Adjustment, Sharpness, Erase Frame, Job Build, Delayed Send, Preview, Job Done Notice, File Name, Subject/Message, Reply-to, E-mail Priority, TX Report, Original Content Orientation, Skip Blank Pages (Optional)	Device Security	Protecting SSD Data [SSD Data Encryption (FIPS 140-3), SSD Lock], Standard SSD Initialize, Initialize (NIST 800-88 PURGE LEVEL), Trusted Platform Module (TPM 2.0), Job Log Conceal Function, Protecting MFD Software Integrity, Checking MFD Software Integrity & Platform Firmware Resiliency (NIST SP800-193) with Automatic System Recovery (Verify System at Startup, Runtime Intrusion Detection), Comply IEEE2600.2 (Common Criteria Certification)
FAX SPECIFICATIONS		Device Management and Auditing	Administrator Password, Digital Certificate And Key Management, Remote Management Two-Factor Authentication, Audit Log, Cooperating with External Security Audit System (Security Information and Event Management), Image Data Logging, Security Policy Setting Device administration and Security administration Passwords
Maximum Number of Connection Lines	2 (2nd Line optional)	ENVIRONMENTAL SPECIFICATIONS	
Modem Speed	Super G3: 33.6 kbps G3: 14.4 kbps	Operating Environment	Temperature: 10 to 30 °C Humidity: 20 to 80 % RH (Relative Humidity)
Compression Method	MH, MR, MMR, JBIG	Power source	220-240 V, 50/60 Hz, 3.9 A
Resolution (dpi)	400x400 (Ultra Fine), 200x400 (Super Fine), 200x200 (Fine), 200x100 (Normal)	Power consumption	Maximum: Approx. 1,500 W Copying (iR-ADV DX C359i/C259i with DADF continuous scan): 575.4 W ^{*1} Printing (iR-ADV DX C359P) [LAN Print (color mode, duplex, with Cassette Feeding unit-AK1)]: 488.5 W ^{*1} Standby: Approx. 40.3 W ^{*1} Sleep mode: Approx. 0.8 W ^{*2} ^{*1} Reference value; measured one unit ^{*2} 0.8 W sleep mode is not available in all circumstances due to certain settings.
Sending/Recording Size	A4, A5*, A6*, B5*/A4, A5, B5 *Sent as A4		Typical Electricity Consumption (TEC)*: iR-ADV DX C359i/C359P: 0.33kWh iR-ADV C259i: 0.22kWh ^{*As per USA Energy Star 3.0}
FAX memory	Up to 30,000 pages (2,000 jobs)		For detailed information relating to Erp:Lot6/26 regulation, please go to: https://www.canon-europe.com/for_work/lot26/
Speed dials	Max. 200	Noise levels	Sound Power Level (LWA, m*) Active (BW) (1-sided): iR-ADV DX C359i/C359P: 65 dB, Kv 3 dB iR-ADV DX C259i: 62 dB, Kv 3 dB ^{*Reference value; measured only one unit with ISO7779, described with ISO9296 (2017)} Sound Pressure (LpAm) Bystander's position: Active (BW) (1-sided): iR-ADV DX C359i/C359P: 52 dB* iR-ADV DX C259i: 49 dB* Standby: iR-ADV DX C359i/C359P/C259i: 8 dB ^{*Reference value; measured only one unit with ISO7779, described with ISO9296 (2017)}
Group dials/destinations	Max. 199 dials		Standards Blue Angel
Sequential broadcast	Max. 256 addresses		CONSUMABLES
Memory backup	Yes		Toner Cartridges C-EXV 55 Toner BK/C/M/Y C-EXV 55 TONER BK: 23,000 pages C-EXV 55 TONER C/M/Y: 18,000 pages
Fax Features	Sender's Name (TTI), Selecting the Telephone Line (when sending fax), Direct Send, Delayed Send, Preview, Job Done Notice, TX Report, Interrupt Transmission, Sequential Broadcasting, Password/Subaddress Sending, Confidential Mailbox, 2 on 1 Log		SOFTWARE AND PRINTER MANAGEMENT
STORE SPECIFICATIONS			Tracking and reporting Universal Login Manager (ULM) ^{*For more information, please refer to uniFLOW Online}
Mail Box (Number supported)	100 User Inboxes, 1 Memory RX Inbox, 50 Confidential Fax Inboxes Maximum 10,000 Pages (2,000 jobs) Stored		Remote management tools iW Management Console eMaintenance Content Delivery System
Advanced Space	Communication Protocol: SMB or WebDAV Supported Client: PC: Windows* 8.1/10 Concurrent Connections (Max.): SMB:64, WebDAV:3		Scanning software Network ScanGear
Advanced Space available disc space	Approx. 16GB		Platform MEAP (Multifunctional Embedded Application Platform)
Advanced Space Features	Authentication for Advanced Space Log-in, Sort Function, Printing a PDF File with a Password, imageWARE Secure Audit Manager Support, Search, File Preview, Authentication Management, Open to public, URI TX, Backup/Restore		Document Publishing Kofax PowerPDF (optional)
SECURITY SPECIFICATIONS			PAPER SUPPLY OPTIONS
Authentication and Access Control	User Authentication (Picture Login, Picture and PIN Login, Card Login, Username and Password Login, Function Level Login, Mobile Login), Department ID Authentication (Department ID and PIN Login, Function Level Login), uniFLOW Online* (PIN Login, Picture Login, Picture and PIN Login, Card Login, Card and PIN Login, Username and Password Login, Department ID and PIN Login, Function Level Login), Access Management System (Access Control), Cloud Connector* (PIN Login), Microsoft Entra ID (PIN Login, Card Login), Two-Factor Authentication at LUI/RUI ^{*Subscription required}		Cassette Module-AEI Paper Capacity: 550 sheets (80 gsm) Paper Type: Thin, Plain, Heavy, Recycled, Color, Pre-punched, Bond Paper Size: A4, A5R, B5, Custom size: 98.0 x 190.5 mm to 216.0 x 355.6 mm Paper Weight: 60 to 163 gsm Power Source: From the Main Unit Dimensions (W x D x H): 511 x 508 x 159 mm (attached to the main unit) Weight: Approx. 10 kg
Document Security	Print Security (Secure Print, Encrypted Secure Print, Forced Hold Printing, uniFLOW Secure Print*), Receive Data Security (Confidential Fax Inbox Forwarding Received Documents Automatically), Scan Security (Encrypted PDF, Device Signature PDF/XPS, User Signature PDF/XPS, Adobe LiveCycle* Rights Management ES2.5 Integration), BOX Security (Mail Box Password Protected, Advanced Space Access Control), Send Data Security (Setting for requesting password input per transmission, Restricted E-mail/File send functions, Confirming FAX number, Allow/Restrict Fax Driver Transmissions, Allow/Restrict Sending from History, S/MIME Support), Document Tracking (Secure Watermark) ^{** Requires uniFLOW Online / uniFLOW}		
Network Security	TLS 1.3, FTPS, IPsec, IEEE802.1X authentication, WPA3 support (Wi-Fi), SNMP V3.0, Firewall Functionality (IP/MAC Address Filtering), Dual Network Support (Wired LAN/Wireless LAN, Wired LAN/Wired LAN), Disabling Unused Functions (Enabling/Disabling Protocols/Applications, Enabling/Disabling Remote UI, Enabling/Disabling USB Interface), G3 FAX separation from LAN, USB Port separation from LAN, Prohibit the execution of files stored in Advanced Space in the MFP, Scan and Send -Virus Concerns for E-mail Reception		

TECHNICAL SPECIFICATIONS

imageRUNNER ADVANCE DX C259/C359 Series

Cassette Feeding Unit-AJ1	<p>Paper Capacity: 550 sheets (80 gsm) Paper Type: Thin, Plain, Recycled, Heavy, Color, Pre-punched, Bond Paper Size: A4, A5R, B5 Custom size: 98.0 x 190.5 mm to 216.0 to 355.6 mm Paper Weight: 60 to 163 gsm Power Source: From the Main Unit Dimensions (W x D x H): 511 x 508 x 425 mm (attached to the main unit) Weight: Approx. 16 kg</p>
Cassette Feeding Unit-AK1	<p>Paper Capacity: 550 sheets (80 gsm) x 3 cassettes Paper Type: Thin, Plain, Recycled, Heavy, Color, Pre-punched, Bond Paper Size: A4, A5R, B5 Custom size: 98.0 x 190.5 mm to 216.0 to 355.6 mm Paper Weight: 60 to 163 gsm Power Source: From the Main Unit Dimensions (W x D x H): 511 x 508 x 425 mm (attached to the main unit) Weight: Approx. 19 kg <small>*Paper capacity may vary with different paper type/size.</small></p>
OUTPUT OPTIONS*	
Staple Finisher-Z1	<p>Tray Capacity (80 gsm): A4, A5, A5R, A6, B5: 500 sheets Paper Weight: 60 to 220 gsm Staple Position: Corner Staple Capacity: A4, B5: 30 sheets (60 to 105 gsm) Power Source: From the Main Unit Dimensions (W x D x H): 555 x 459 x 301 mm (Unit size) Weight: Approx. 14 kg</p>
HARDWARE ACCESSORIES	
Card Readers	<p>Various card readers available e.g. MiCard Plus. Please contact local Canon Office for more details. Copy Card Reader-F1 Copy Card Reader Attachment-B5</p>
SYSTEM AND CONTROLLER OPTIONS	
Print Accessories	PCL International Font Set-A1
Barcode Printing	Barcode Printing Kit-D1
System Accessories	Copy Control Interface Kit-A1 Wireless LAN Board-D1 Serial Interface Kit-K3
FAX Accessories	Super G3 FAX Board-BL1 Remote Fax Kit-A1 IP FAX Expansion Kit-B1
OTHER OPTIONS	
Accessibility Accessories	ADF Access Handle-A1
Consumables	Staple-P1

Software & Solutions



Certifications and compatibility



Canon Ireland
 3006 Lake Drive
 Citywest, Saggart
 Co. Dublin, Ireland
 Telephone No: 01 2052400
 Facsimile No: 01 2052525
 canon.ie

Canon (UK) Ltd
 The Bower
 4 Roundwood Avenue
 Stockley Park
 Uxbridge
 UB11 1AF

Canon Electronics Inc.
 canon-elec.co.jp
Canon Europe
 canon-europe.com
 English edition
 © Canon Europa N.V., 2024

